



Elite Electronic Engineering, Inc.
1516 Centre Circle
Downers Grove, IL 60515
630-495-9770
www.elitetest.com

NOTE: FOR ELITE CUSTOMER USE ONLY. Information listed here is subject to revision without notice. Actual chamber performance will depend on test item and specification requirements. Contact Elite for current test equipment information and test application assistance.

EMI CHAMBER DESCRIPTION

TEST SUITE 26

Test Room ID: R26A

Description:	SHIELDED TEST ENCLOSURE
Primary Testing Uses:	AUTOMOTIVE; Conducted Immunity & Emissions
Dimensions:	4.88m x 3.66m x 3.05m (16ft. x 12ft. x 10ft.) [see Figure – 2 below]
Construction:	2 Layers Galvanized Steel <i>Ground Plane Bonding: Copper Straps</i>
Ground Plane Dimensions:	3.55m x 1.26m x 0.78mm (11ft. 9in. x 4ft.2in. x 0.031in.) [see Figure – 2 below]
Power Availability:	External AC/DC 30A Filtered Power External 60A Filtered DC Power Note: Other power arrangements are available upon request.



Elite Electronic Engineering, Inc.
1516 Centre Circle
Downers Grove, IL 60515
630-495-9770
www.elitetest.com

NOTE: FOR ELITE CUSTOMER USE ONLY. Information listed here is subject to revision without notice. Actual chamber performance will depend on test item and specification requirements. Contact Elite for current test equipment information and test application assistance.

EMI CHAMBER DESCRIPTION

TEST SUITE 26



Figure - 1: Room 26A (Test Room)



Elite Electronic Engineering, Inc.
1516 Centre Circle
Downers Grove, IL 60515
630-495-9770
www.elitetest.com

NOTE: FOR ELITE CUSTOMER USE ONLY. Information listed here is subject to revision without notice. Actual chamber performance will depend on test item and specification requirements. Contact Elite for current test equipment information and test application assistance.

EMI CHAMBER DESCRIPTION

TEST SUITE 26

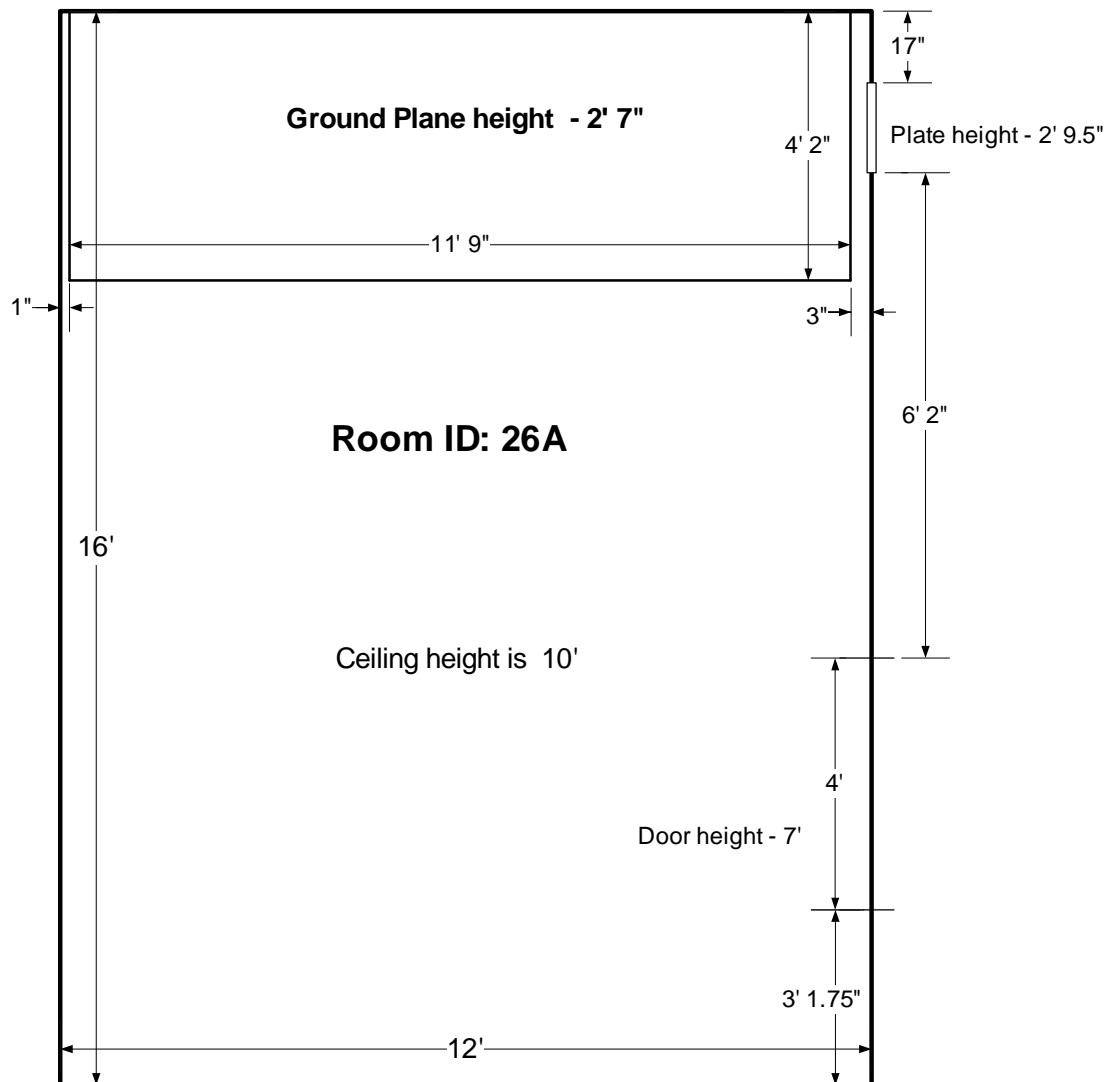

Figure - 2: Room 26A



Elite Electronic Engineering, Inc.
1516 Centre Circle
Downers Grove, IL 60515
630-495-9770
www.elitetest.com

NOTE: FOR ELITE CUSTOMER USE ONLY. Information listed here is subject to revision without notice. Actual chamber performance will depend on test item and specification requirements. Contact Elite for current test equipment information and test application assistance.

EMI CHAMBER DESCRIPTION

TEST SUITE 26

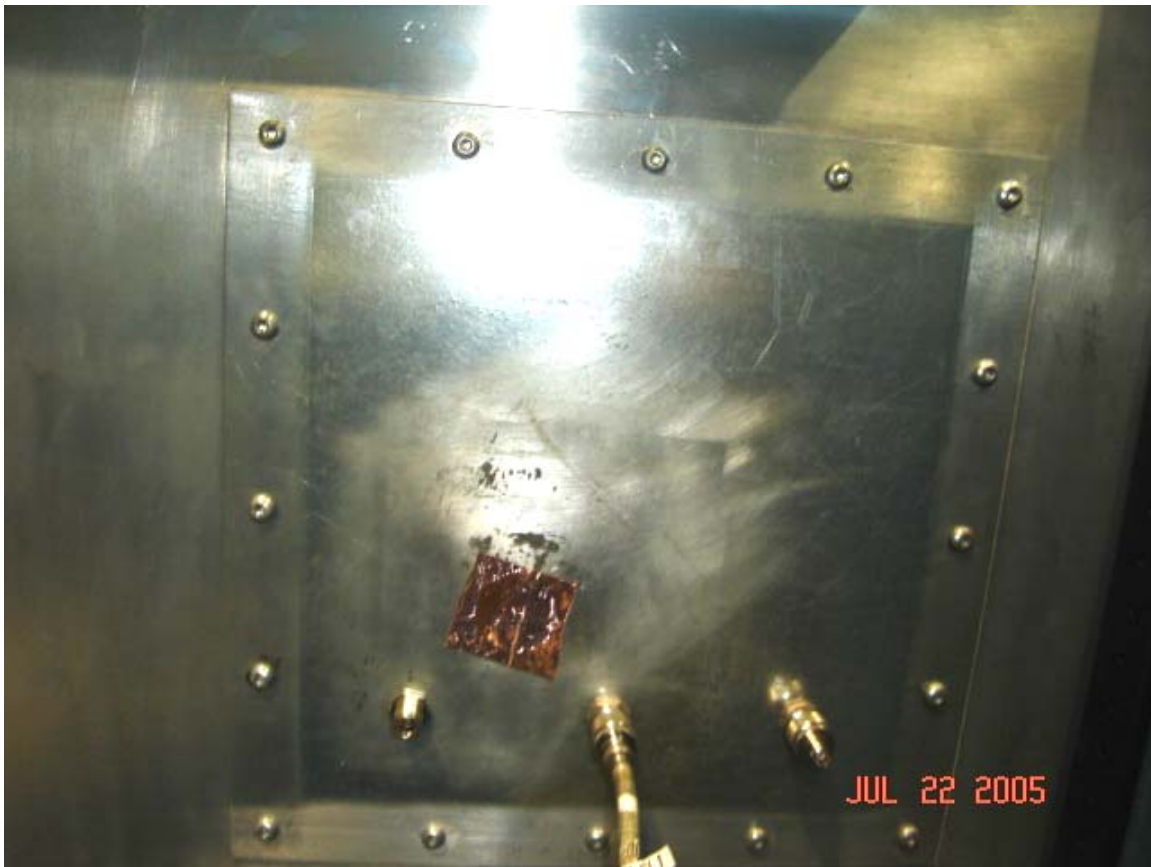
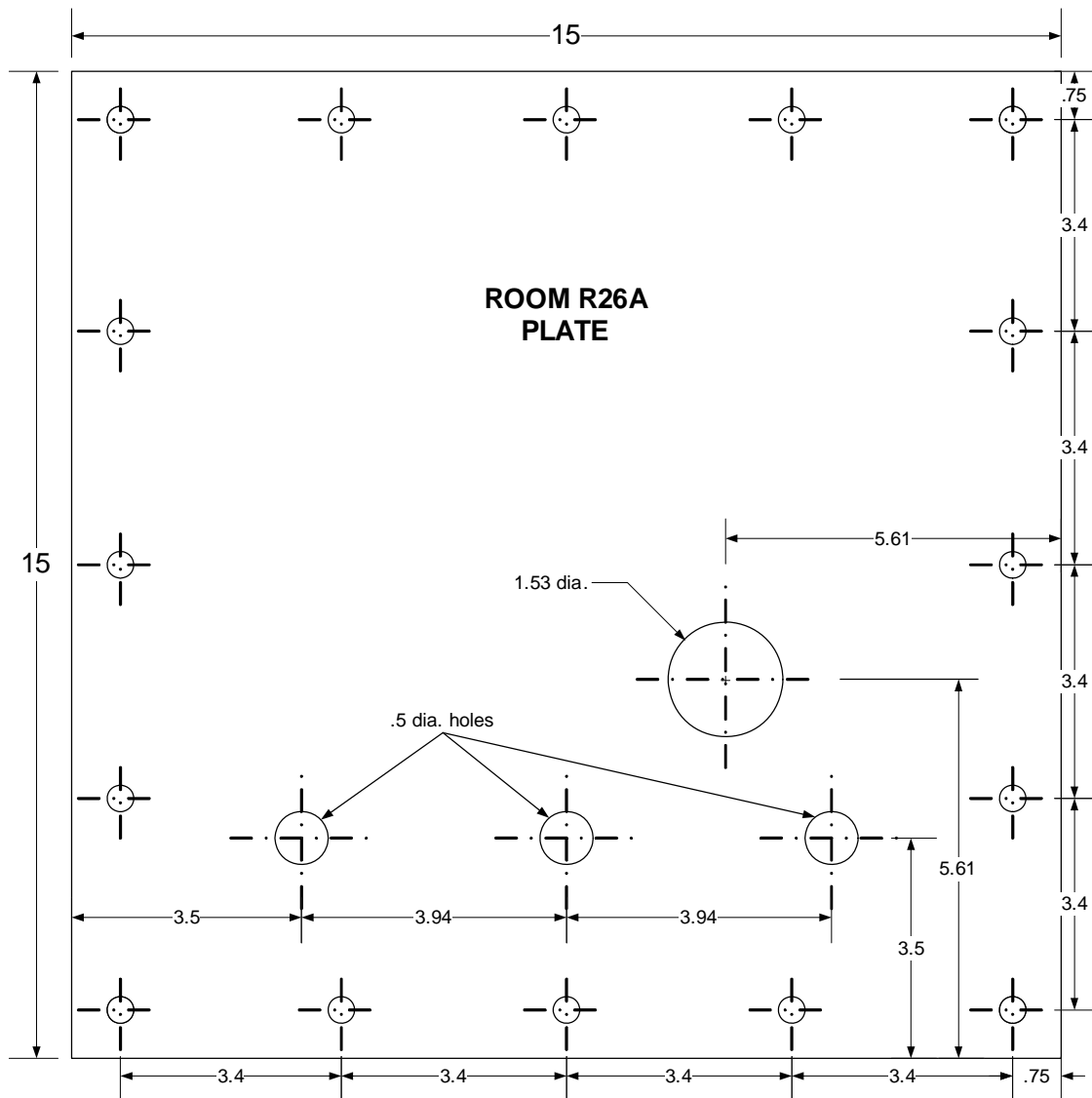

Figure - 3: Room 26A (Test Room) Outer Mounting Plate
(View from outside chamber)



EMI CHAMBER DESCRIPTION

TEST SUITE 26



Mounting holes are 5/16"

All dimensions are in inches

Figure - 4: Room 26A (Test Room) Outer Mounting Plate Dimensions